



TUTHILL PUMP GROUP

ENGINEERED | solutions



FlowPro Family of Process Pumps



We took what you said and built on it.

When the engineers at Tuthill asked what you wanted in a high-viscosity process pump, you didn't hold back. You said you wanted a tough, reliable pump. You said you wanted a modular design that can evolve with your changing needs. You said you wanted a pump designed to reduce your inventory. You said you wanted ease of maintenance. And you said you wanted an alternative with minimal switching costs. We turned what we learned into a pump that delivers unparalleled built-in value.

You said you wanted a tough, reliable pump.

GlobalGear® builds on a time-tested design and more than 75 years of gear pump engineering experience. Capable of tackling the toughest high-viscosity applications, it's good to go for bulk transfer, chocolate processing, asphalt, high-temperature fluids and chemical processing.

Tough Gears

Tough gear materials can handle the stresses of high-viscosity and high-pressure operation.

- Ductile Iron in iron models
- Nitronic® 60 in stainless models

Strong Shaft Design

High-strength alloys and oversized diameters ensure strong, reliable shafts.

- AISI 4140 in iron models
- 17-4 PH in stainless models

Robust Bearing

Oversized ball bearings are used to ensure years of trouble-free operation.

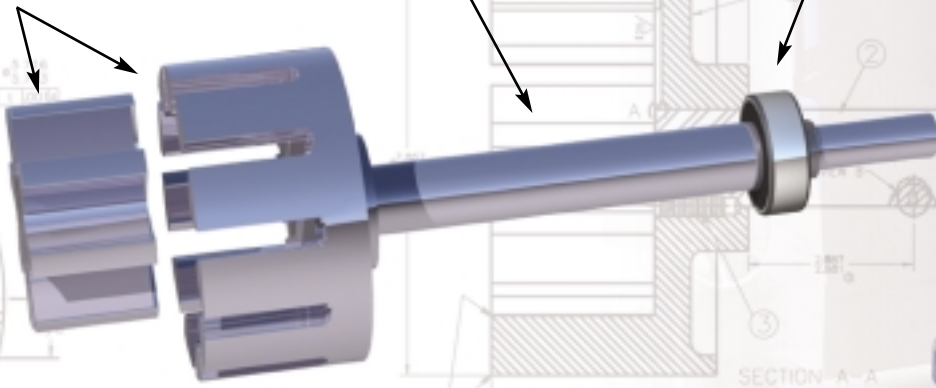

**Tuthill tough. And flexible—
for the way you work.**

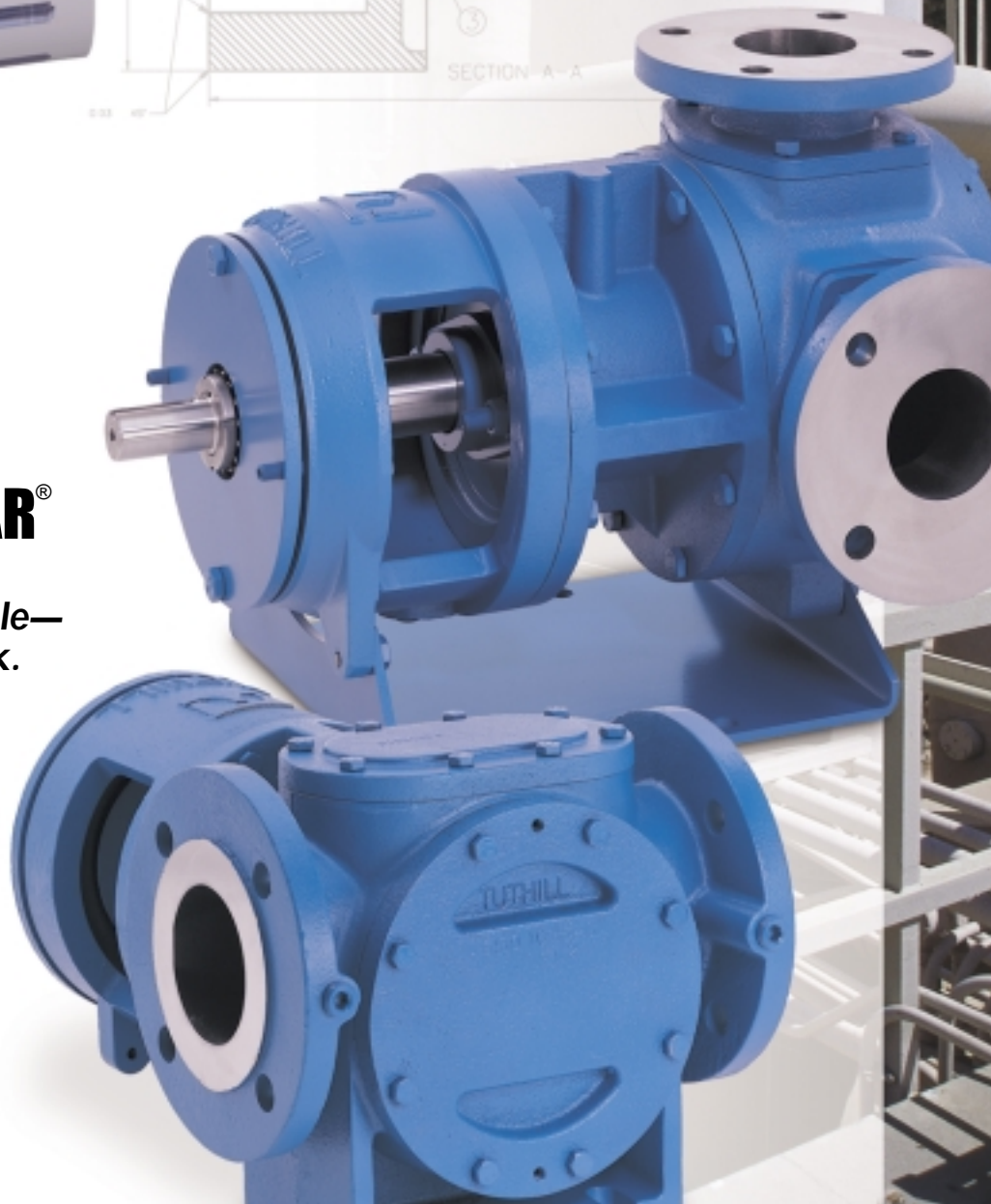

You said you wanted a modular design that can evolve with your changing needs.

Modular Ports

Several port styles are available to match your piping needs:

- Side-Side or Side-Top port positions
- NPT tapped
- BSPT tapped
- ANSI 125#/150# flanged
- ANSI 250#/300# flanged
- ISO PN16 flanged
- ISO PN40 flanged



Each pump size has numerous port size choices to minimize piping losses. For example, GG200 size offers these choices:

- 2" or 50mm
- 2 1/2" or 65mm
- 3" or 80mm
- 4" or 100mm

Shown: GG 200 with 2" NPT side port and ANSI 125# top port

Modular Seal Chamber

Modular seal chamber provides a choice of packing, mechanical seal or cartridge seal—without changing major pump components.

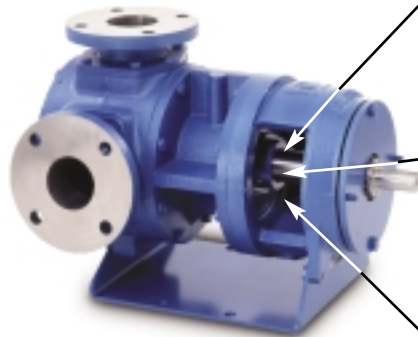
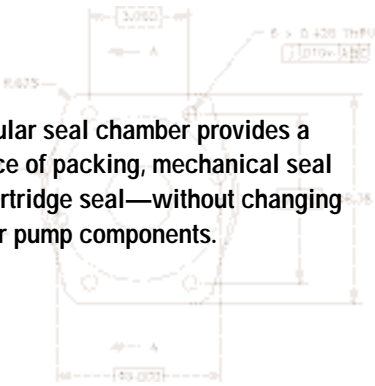

Packing



Cartridge Seal



Mechanical Seal

You said you wanted a pump designed to reduce your inventory.

Standard Shaft Sizes

Standard shaft sizes let you use seals you probably already have for other rotating equipment. And this applies no matter where you are, because GlobalGear® pumps are available with your choice of nominal inch or metric shaft sizes.

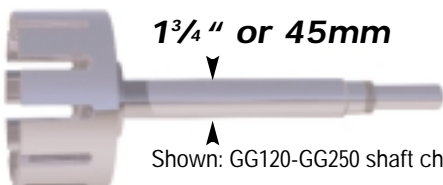

1 3/4" or 45mm

Shown: GG120-GG250 shaft choices

Spare Drive Modules

The back pull-out design allows you to stock a spare drive module instead of a complete pump.

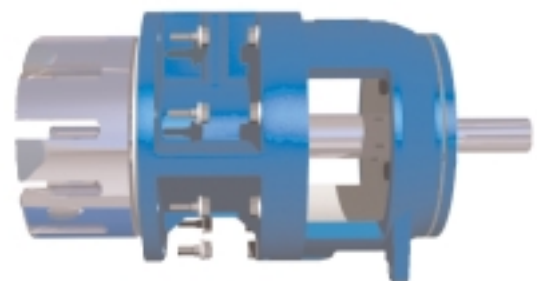

You said you wanted ease of maintenance.

Back Pull-Out

The back pull-out design greatly reduces downtime for service—the pump can be repaired without disturbing piping or shaft alignment.

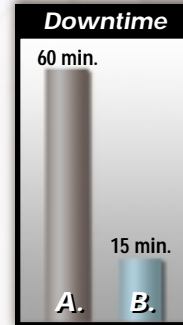
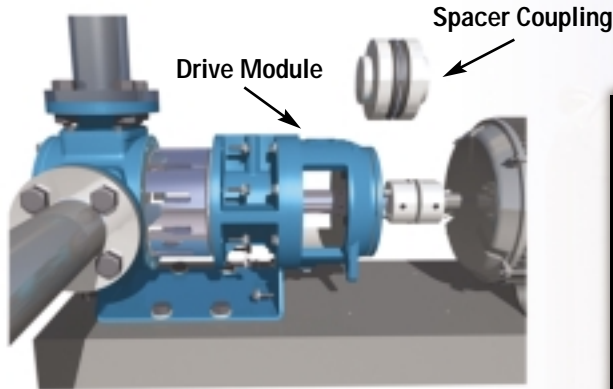

- A. Typical time to replace complete pump
- B. Typical time to replace GlobalGear® drive module

Downtime

120 min.

40 min.

A.

B.

- A. Typical time to replace seal in pump without inline feature
- B. Typical time to replace seal in GlobalGear® pump

Inline Seal Access

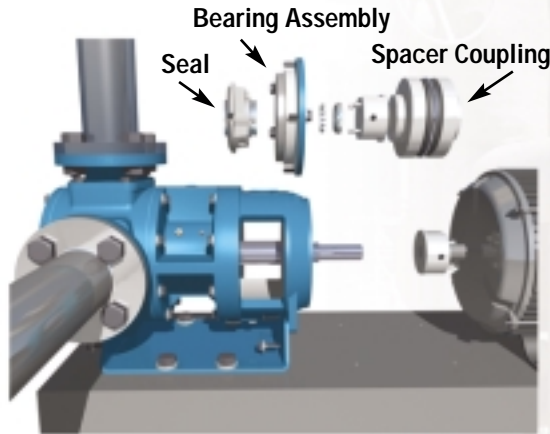

Inline seal access design reduces seal maintenance time—the seal can be removed without disturbing the piping or shaft alignment.

You said you wanted an alternative with minimal switching costs.

No Piping Changes

GlobalGear® mounting dimensions match those of most other gear pumps.

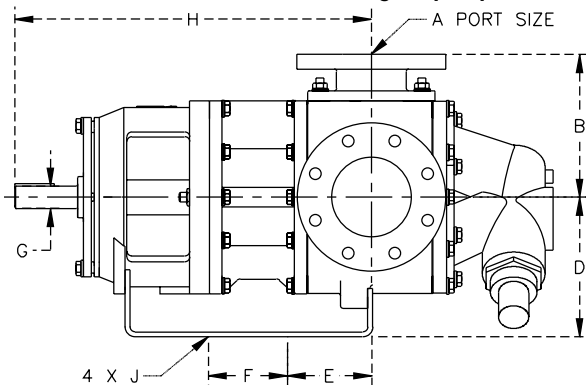

No Drive Changes

At any given speed, the GlobalGear's flow rates match those of most other gear pumps.

Flow Rate

100 GPM 100 GPM

A.

B.

- A. GG130 at 780 RPM
- B. Other gear pump at 780 RPM

Specifications

Cast Iron

Model	Max RPM	Flowrate at Max RPM USGPM	M ³ /HR
GG015	1800	15	3.4
GG030	1800	30	6.8
GG050	1500	50	11
GG070	1500	70	16
GG080	1500	80	18
GG090	1500	90	20
GG120	1200	120	27
GG130	1000	130	30
GG200	1000	200	45
GG210	800	210	48
GG250	750	250	57

Pressures to 200 psi (13.8 bar)
 Temperatures to 600°F (316°C)
 Viscosities to 1,000,000 ssu (220,000 cst)

Stainless Steel

Model	Max RPM	Flow Rate at Max RPM USGPM	M ³ /HR
GG015	1200	10	2.3
GG030	1200	20	4.5
GG050	1000	33	7.6
GG070	1000	47	11
GG080	1000	53	12
GG090	1000	60	14
GG120	800	80	18
GG130	640	83	19
GG200	640	128	29
GG210	520	137	31
GG250	520	173	39

Pressures to 150 psi (10.3 bar)
 Temperatures to 500°F (260°C)
 Viscosities to 1,000,000 ssu (220,000 cst)

Maximum Speeds

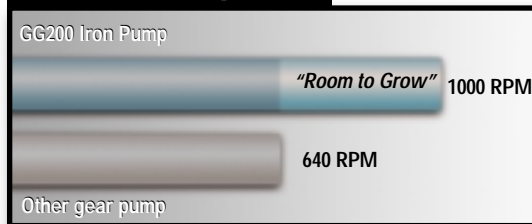

Faster top speeds allow increased flow rate if needs change.

To find out more about how GlobalGear® process pumps can fit your application needs, call your authorized distributor today.

To find an authorized distributor, visit www.tuthillpump.com/distributors.

Tuthill Pump Group
 12500 South Pulaski Road
 Alsip, Illinois 60803 USA
 phone: (708) 389-2500
 fax: (708) 388-0869
 email: tuthillpump@tuthill.com

Tuthill Latin America
 1320 South Dixie Highway, Suite 761
 Coral Gables, Florida 33146 USA
 phone: (305) 740-3381
 fax: (305) 740-9328
 email: tuthill.latinamerica@tuthill.com

Tuthill Asia
 Room 908 - 910, Kornhill Metro Tower
 N°1 Kornhill Road - Quarry Bay Hong Kong
 phone: 852 2513 7113
 fax: 852 2513 7793
 email: tuthill@netvigator.com

Tuthill Europe
 Parc industriel Wavre Nord
 Avenue Vesale, 30 - 1300 Wavre - Belgium
 phone: 32 10 22 83 34
 fax: 32 10 22 83 38
 email: tld@tuthill.com

Tuthill Pump Group
 Birkdale Close
 Manners Industrial Estate
 Ilkeston, Derbyshire DE7 8YA England
 phone: 44.115.932.5226
 fax: 44.115.932.4816
 email: tuthilluk@tuthill.com



www.tuthillpump.com

Tuthill Australia
 19/21 Milton Park, 128 Canterbury Road
 Box 71, Kilsyth, Victoria, 3137
 phone: 61 3 9720 6533
 fax: 61 9 9720 6880
 email: tuthillaus@bigpond.com